

SPECIALTY WALL PANELS



All TMI catalog sections are available online at: www.tmisystems.com/products.html

WALL PANELS

The TMI wall panel system is engineered to be a visually appealing and cost effective solution for simplified wall treatment applications. The wall panels are finished with VGS (0.028") laminate and edges are treated with machine applied 1mm PVC edgebanding. Various core material options are available. Extruded aluminum Z-clips are included by TMI, and attached during jobsite installation.

NOTES:

Core Material Options:

- Wall Panels - Industrial Grade Particleboard, MDF, or Combination Core Plywood
- Reveal Panels - MDF

Finish Materials:

- Wall Panels - VGS (0.028") Laminate, balanced with CLS (0.024") or VGS (0.028") Laminate
- Reveal Panels - TFL or VGS (0.028") Laminate

Edgebanding Options:

- Wall Panels - Machine applied 1mm PVC matched to the laminate selection when available

Panel Sizes:

- Maximum - 47" Wide x 95" High
- Utilize typical panel widths of 23 1/2" and 47" to minimize cost impact.
- Core Material - 3/4" thickness for Wall Panels, 1/4" or 5/32" thickness for Reveal Panels
- Reveal Dimensions - 3/8" to 1" maximum

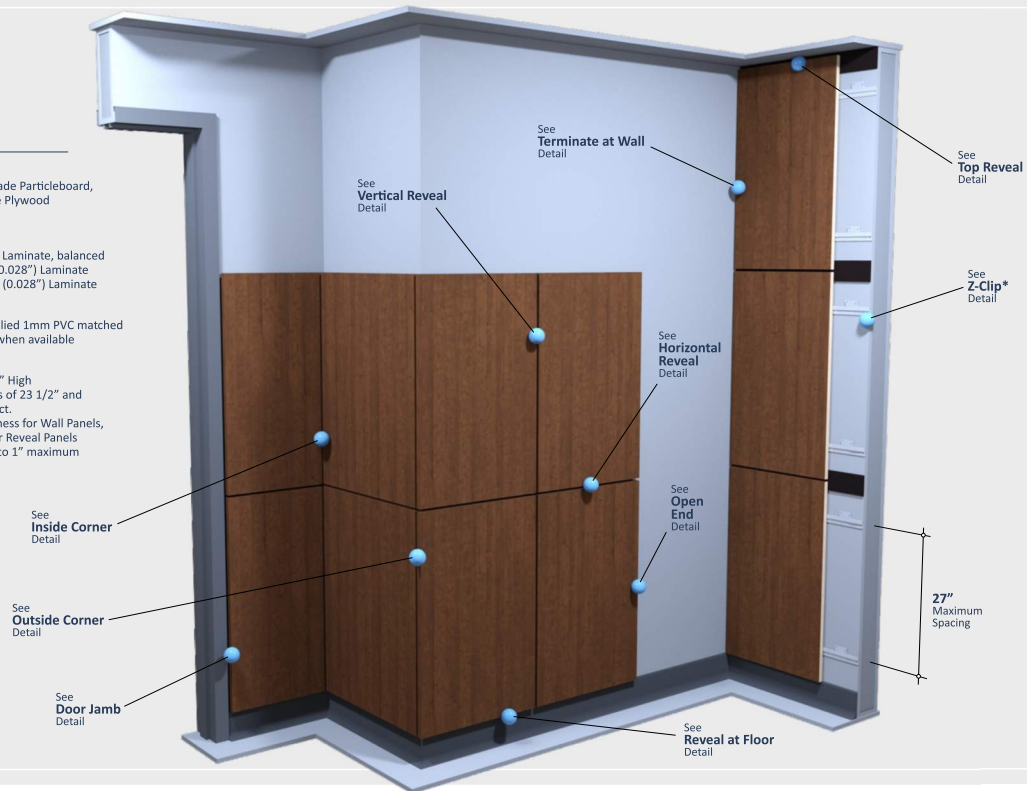

Z-CLIP DETAIL

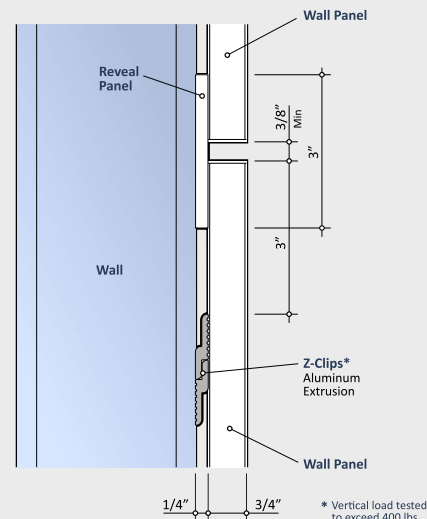
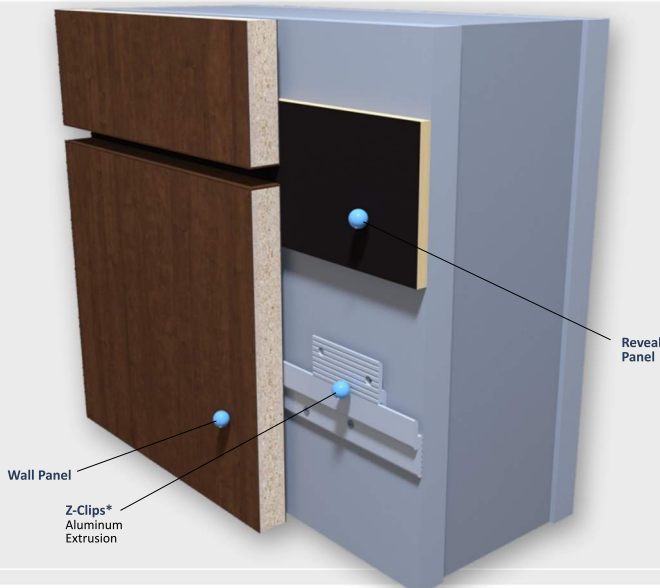

SPECIALTY WALL PANELS



All TMI catalog sections are available online at: www.tmisystems.com/products.html

TOP REVEAL DETAIL

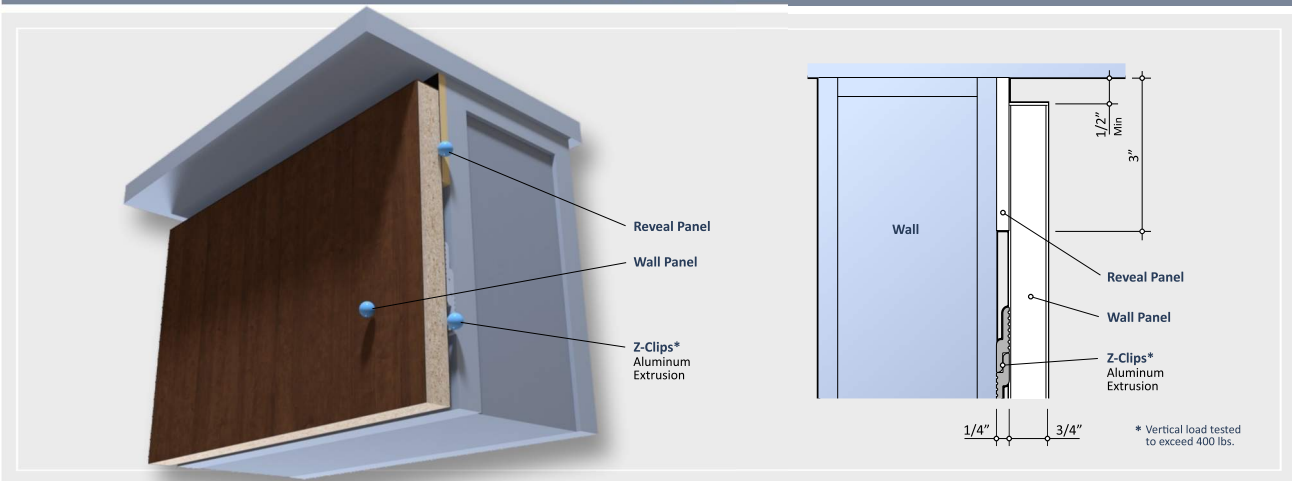

HORIZONTAL REVEAL DETAIL

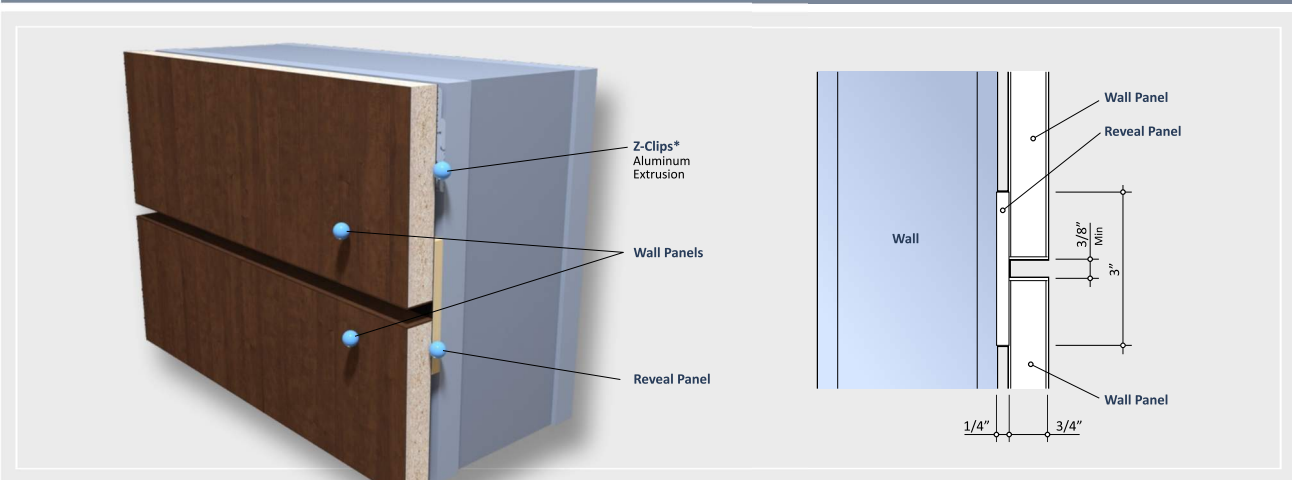

REVEAL AT FLOOR DETAIL

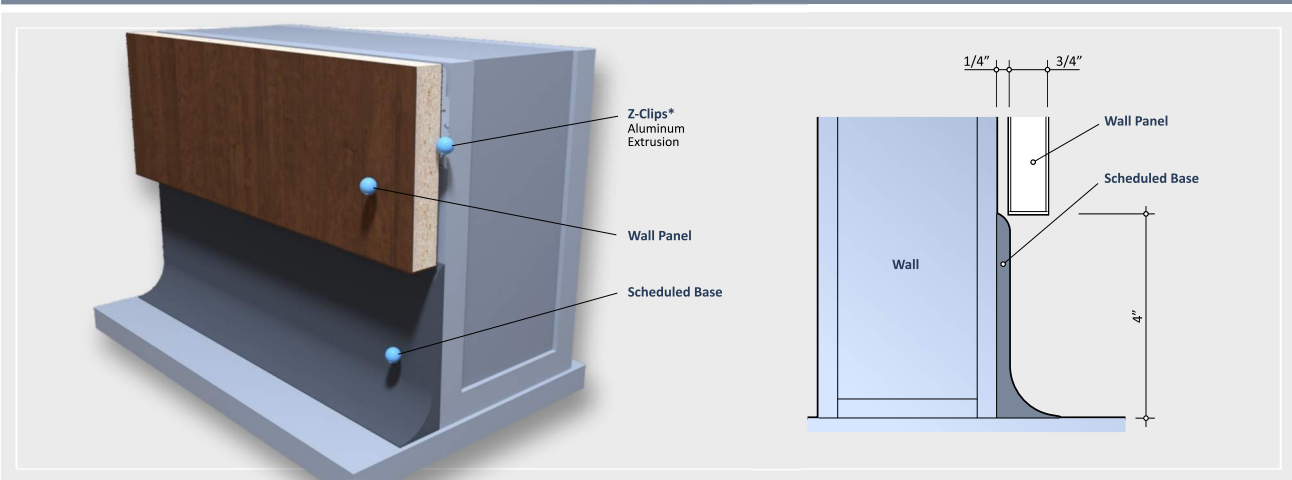

SPECIALTY WALL PANELS



All TMI catalog sections are available online at: www.tmisystems.com/products.html

VERTICAL REVEAL DETAIL

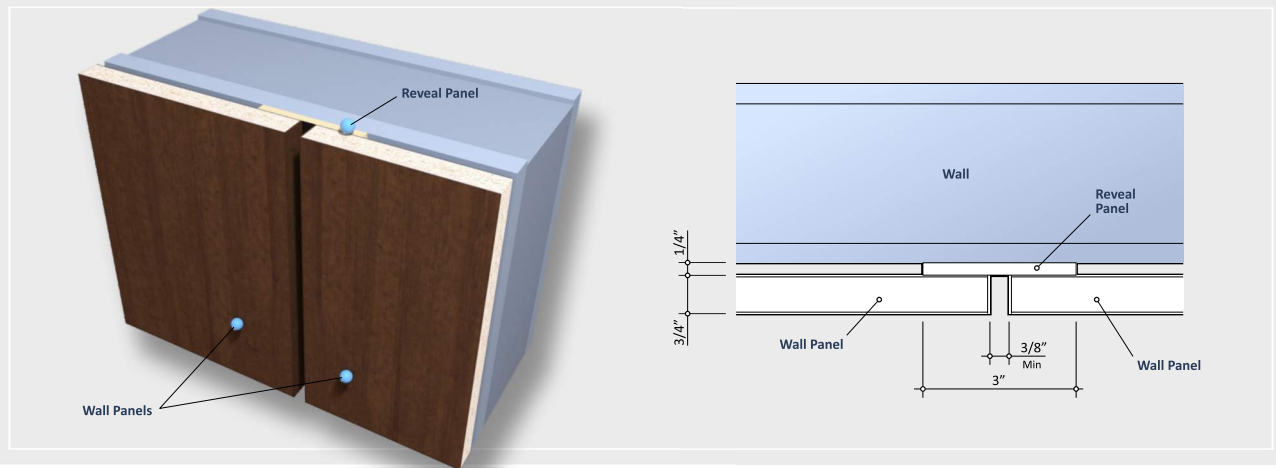

OPEN END DETAIL

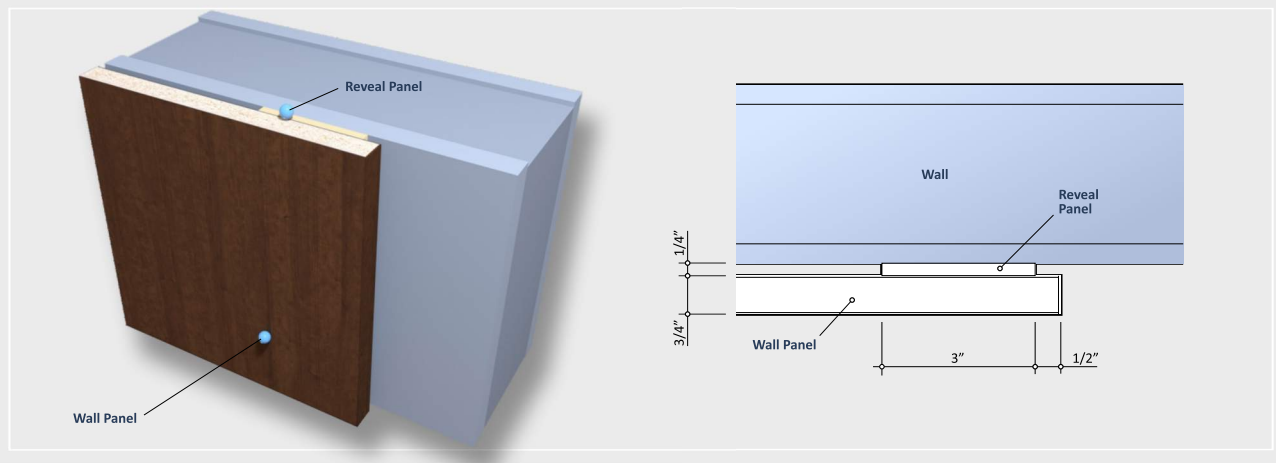

DOOR JAMB DETAIL

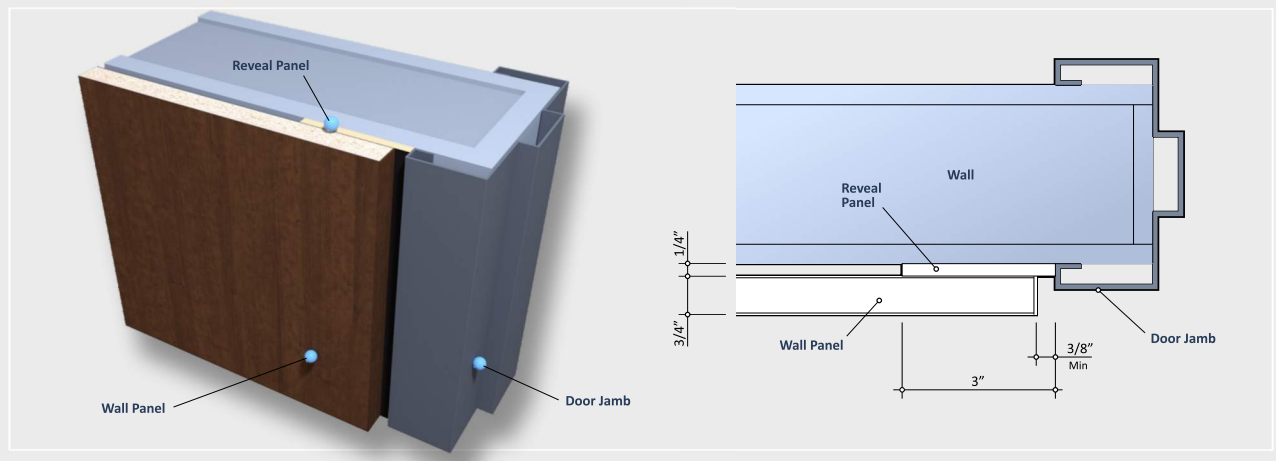

SPECIALTY WALL PANELS



All TMI catalog sections are available online at: www.tmisystems.com/products.html

OUTSIDE CORNER DETAIL

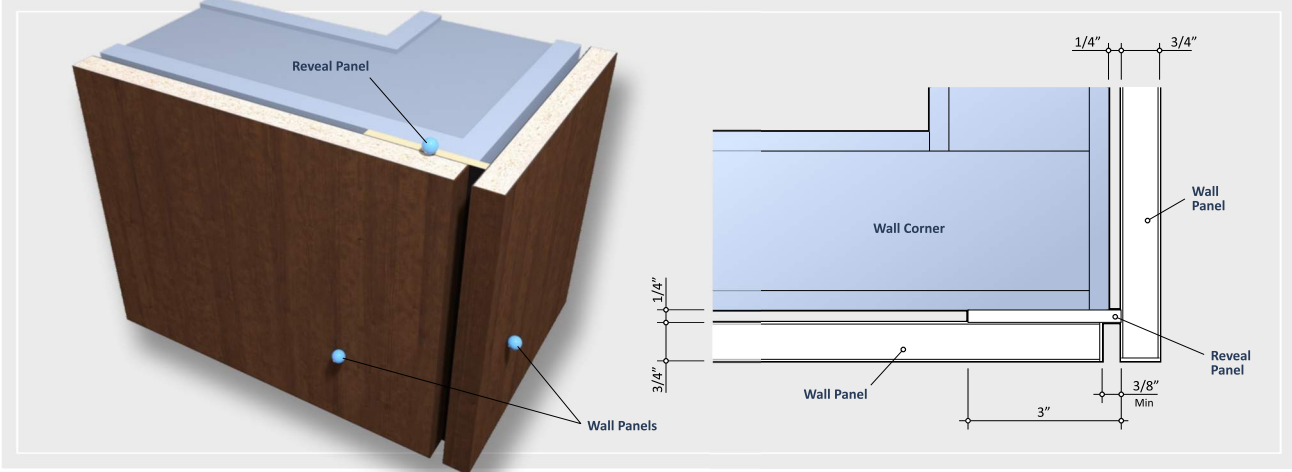

INSIDE CORNER DETAIL

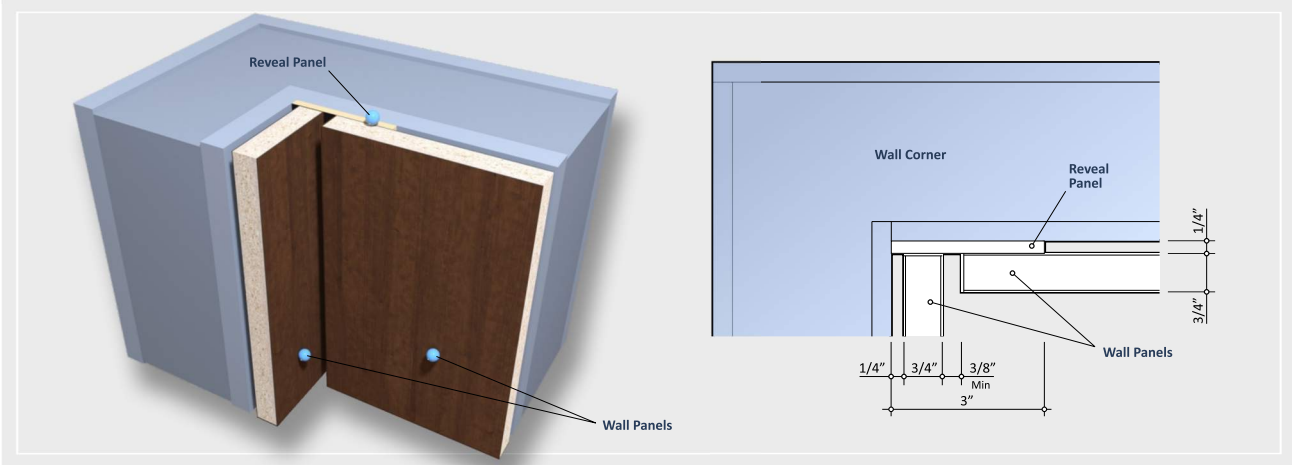

TERMINATE AT WALL DETAIL

